

MPB Center Bar & Inboard Levelers

12970 Branford Street Unit M, Arleta, CA 91331 Phone 1-800-480-6427
Email: microfence@microfence.com Website: www.microfence.com

The **Micro Fence® Edge Guide** can be attached to our Micro Plunge Base and used to cut small circles. For circles from approximately ½" to 12", (12.7mm to 300mm) a **Center Bar** attaches to the edge guide and provides a center pin that can be positioned virtually as close to the bit as you wish.

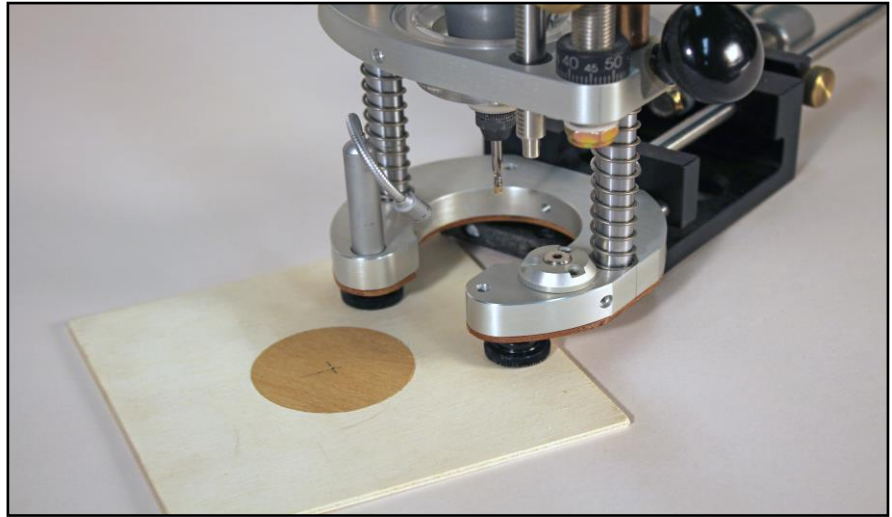

This kit includes two adjustable **Inboard Levelers** that support your Micro Plunge parallel to the work surface. This set-up provides an efficient solution for jobs such as guitar rosette inlays, small speaker cut-outs, wheels for toys, plinth block rosettes, miniatures, or any small circle requirements.

Check the packaging to be sure you have all the parts numbered in the diagram below.

The kit includes:

- # 1 The Center Bar with Pin & Set Screw
- # 2 Two Threaded Levelers
- # 3 One Set Screw
 - 5" of Teflon Tape (not shown)
 - 5/64" Allen Wrench (not shown)

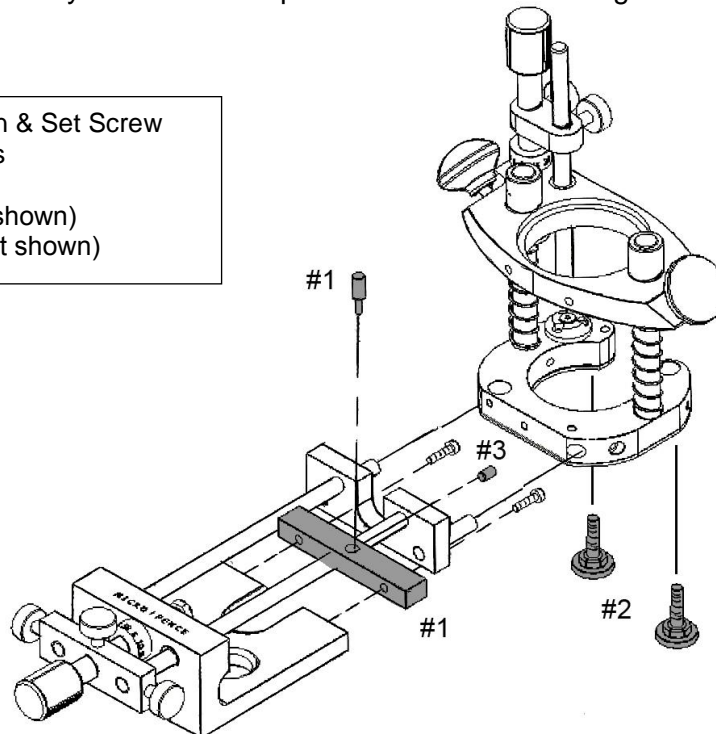

Initial Set-up:

Install the two slotted levelers (**#2**) with the black plastic slides positioned downward. There are two tapped holes in the bottom of your Micro Plunge base. Use the locknut to lock in the levelers when the desired height is achieved.

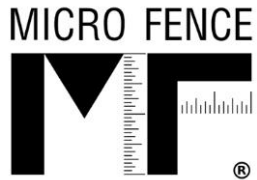

MPB Center Bar & Inboard Levelers

12970 Branford Street Unit M, Arleta, CA 91331 Phone 1-800-480-6427
Email: microfence@microfence.com Website: www.microfence.com

The Center Bar (#1) should be installed on the **Micro Fence®** Body in the same position (and using the same mounting holes), that is used for the wooden straight-line fences and the half-rounds included with each model. Your **Micro Fence®** Edge Guide is packaged with the 8-32 X 1/2" fillister-head screws you'll need to mount the Center Bar.

At this point, if you would like, you can apply sections of the Teflon tape supplied to the bottom of the **Micro Fence®** body. This will make the set-up slide smoothly on the work surface.

Remove the center pin after loosening the nylon-tipped set screw. After installing the **Micro Fence®** Edge Guide on the Micro Plunge Base, set the assembly on a flat surface and adjust the levelers to contact the surface. You can check your settings with the back end of set of dial calipers. The stainless steel levelers feature twenty-pitch threads, so each complete turn will move the leveler **.050"** up or down (**50 thousandths**).

The Center Pin has a 5/32" diameter (3.968mm) and 3/8", (9.525mm) long spike that will act as your pivot point. We recommend drilling a 1/8", (3.175mm) pilot hole and pressing or tapping the pin into it before sliding the Center Bar/Micro Fence assembly on to it. Proper set-ups are show in the drawing below and the photo on the previous page.

SAFETY TIPS:

CAUTION! FASTEN YOUR WORKPIECE SECURELY!

If your intent is to cut all the way through your work-piece, be *absolutely* sure to fasten both the finished and scrap portions of the material before cutting. Kick backs can cause spoiled work or injury.

Options for securing your work include: two-sided tape, temporary gluing/nailing/pinning, or clamping techniques. Try a conservative test cut or 'dry run' before addressing the final operation.

Suspending your power cord above the router can simplify cord management during circular cutting operations.

View of Assembled Kit

